



80-08 型複合式釋氣閥可將水管內空氣大量排出，以減少空氣造成的噪音、震動，提高設備效率。當管內有負壓產生時，複合式釋氣閥會迅速打開吸入外界空氣，以保護管線不受負壓所產生的損壞。

Model 80-08 The Combination Air Release Valve can exhaust huge amounts of air inside the water pipe to reduce the noise and vibration caused by the air, and to enhance the efficiency of the equipment. When there is negative pressure generated inside the pipe, the Combination Air Release Valve will quickly open to suck in the outside air to protect the pipe, so that it won't be damaged by the negative pressure.

結構材質 Material of Construction

No.	Parts Name	Material
1	防護罩 Hood	不鏽鋼 / 碳鋼 SUS / Carbon Steel
2	上蓋 Cover	不鏽鋼 / 碳鋼 SUS / Carbon Steel
3	墊圈 Gasket	EPDM
4	浮筒 Float	不鏽鋼 Stainless Steel
5	閥體 Body	不鏽鋼 / 碳鋼 SUS / Carbon Steel

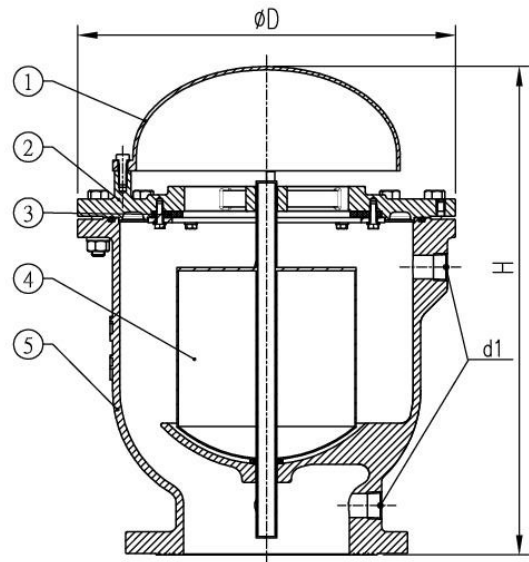

閥門規格 Specification

閥門尺寸 Valve Size	D (mm)	H (mm)	d1 (PT)
8"	460	595	1"
16"	780	850	1"

最大工作壓力 Max working pressure : 10 bar

最大工作溫度 Max working temperature : 100°C

※如需更高工作壓力，可接單生產

If need for very high working pressure, can be made to order.

※寶閥公司保留不經事先通知及對其閥門型號、尺寸逕行更改之權利！

King-Tech reserves the right to make any revisions on the valve model and size without prior notification.

寶閥精密工業股份有限公司

King-tech Valve Precision Industry Inc.



臺北市新生北路二段 127 巷 47 號 1F

www.kingtech-valve.com

E-mail: sb.wow@msa.hinet.net

經銷商 Distributor